

THIS COPY IS PROVIDED ON A RESTRICTED BASIS AND IS NOT TO BE USED IN ANY WAY DETRIMENTAL TO THE INTERESTS OF PANDUIT CORP.

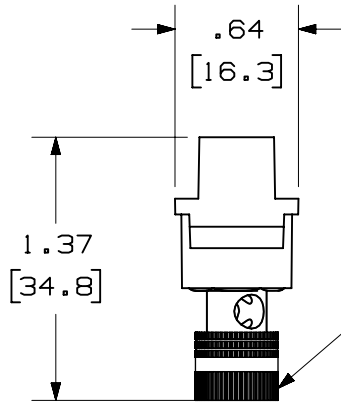

KNURLED NUT WITH COLOR BAND

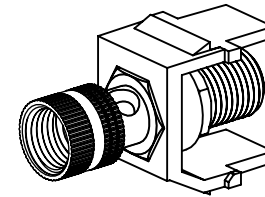
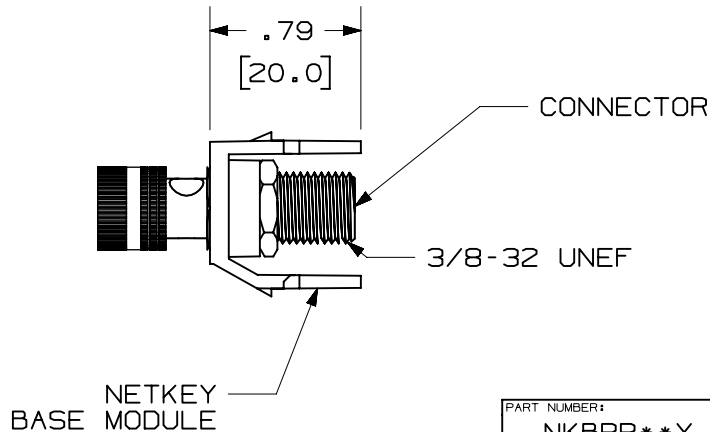
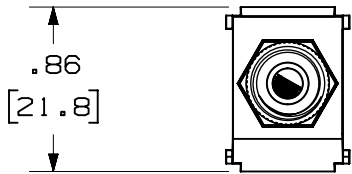

PANDUIT P/N	WEIGHT
NKBPR**Y	.25 LB/10 PCS (115.2 g/10 PCS)
NKBPB**Y	.25 LB/10 PCS (115.2 g/10 PCS)

NOTES:

1. SEE CURRENT CATALOG FOR ADDITIONAL PART NUMBER SUFFIXES TO INDICATE COLOR AND OR PACKAGE QUANTITY.
2. SEE CATALOG FOR COMPLETE LIST OF PARTS APPLICABLE FOR USE WITH THIS PART.
3. DIMENSIONS IN PARENTHESES ARE IN METRIC.

PART NUMBER: NKBPR**Y, NKBPB**Y	PRODUCT SPECIFICATION NUMBER: NA
FMEA/CONTROL PLAN NUMBER: NA	PACKAGING INSTRUCTION NUMBER: NA
INSPECTION INSTRUCTION NUMBER: NA	WORK INSTRUCTION NUMBER: NA

TITLE
NETKEY 5-WAY BINDING POST MODULE
CUSTOMER DRAWING

ITEM REVISION NAME M00741A0/01	PANDUIT
DATASET FILE NAME M00741A0_DC73/01A	
UNLESS OTHERWISE SPECIFIED, DIMENSIONAL TOLERANCES ARE: IN [mm] .x ± .1 [2.54] .xxx ± .005 [.127] .xx ± .01 [.25] ANGLES ± 5 °	MATERIAL: CONNECTOR - GOLD PLATED BRASS NETKEY MODULE - ABS
THIRD ANGLE PROJECTION	DRAWING NUMBER: 00741-73

REV	DATE	BY	CHK	APR	DESCRIPTION	ECN
1	5-12-17	MDJR	NAGL	AMY	A. UPDATED ASSEMBLY MODEL VIEWS AND TITLE BLOCK	00741-73
R	10-2-01	JSP	MJD	MJD	RELEASED TO PRODUCTION	00741-73

REV	DATE	BY	CHK	APR	DESCRIPTION	ECN
JSP	10-2-01	MJD	FULL	SHT 1 OF 1	A	

D10100DA/14